



INVENTORIES

**Sample floor plan in
2D and 3D**

Floor Plan

Approx. 63.3 sq. metres (680.8 sq. feet)

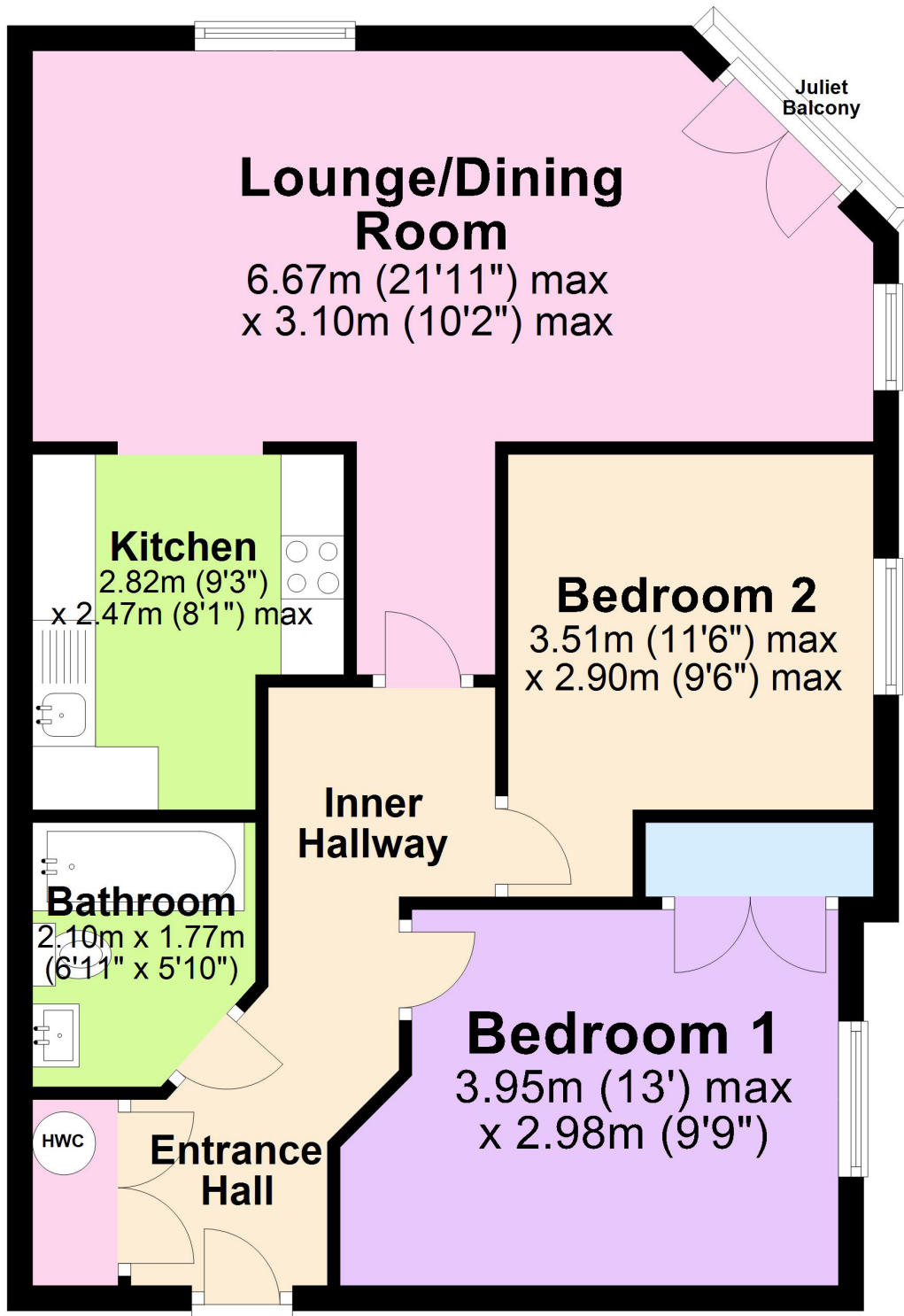

Total area: approx. 63.3 sq. metres (680.8 sq. feet)

Illustrations are for viewing purposes only. Measurements are not to scale. Property Total and Floor Totals are Internal figures only and do not include Garden, Balconies, Patios or Terraces if any shown. Drawn by SPG.

Floor Plan

Approx. 63.3 sq. metres (680.8 sq. feet)

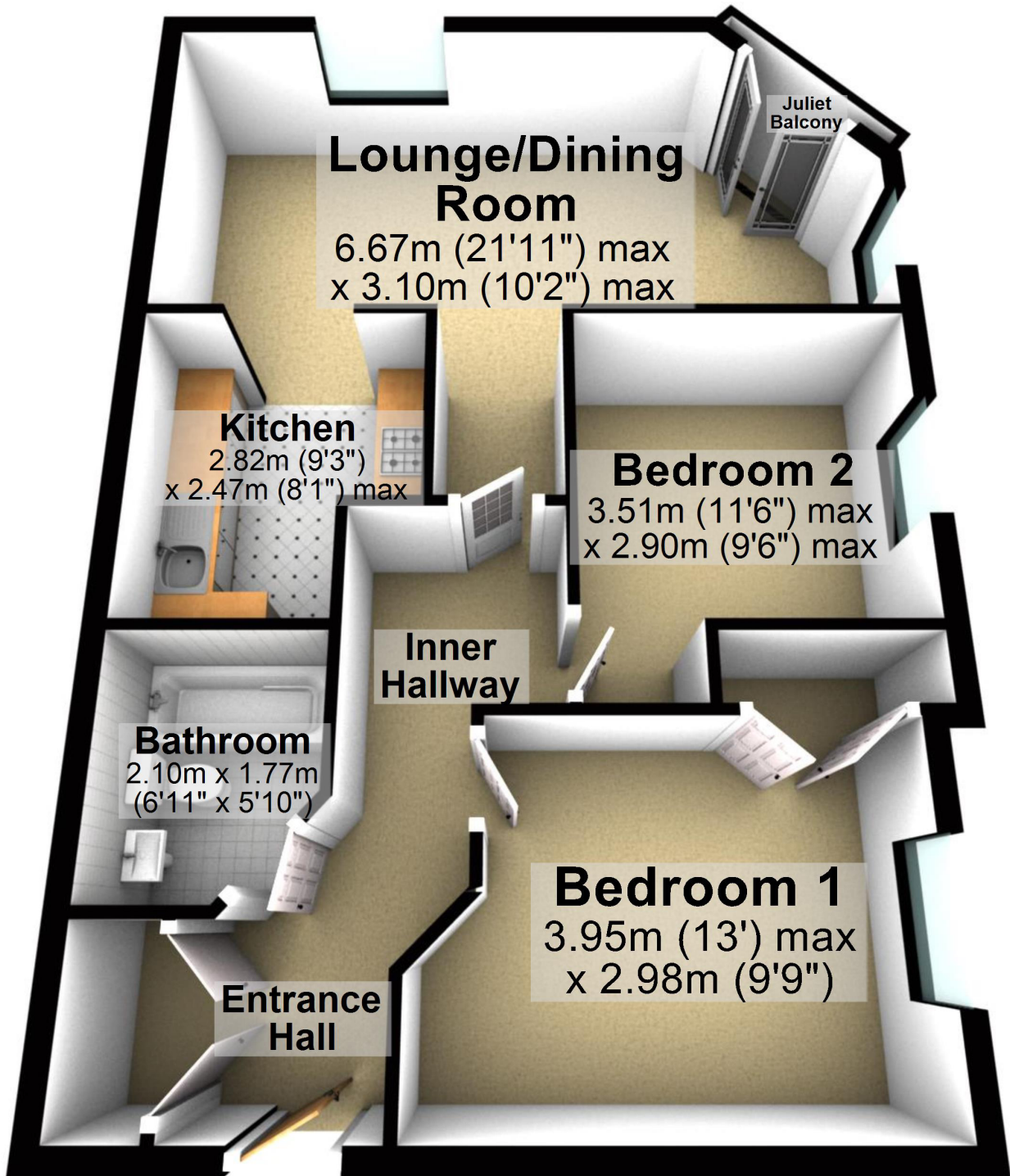

Total area: approx. 63.3 sq. metres (680.8 sq. feet)

Illustrations are for viewing purposes only. Measurements are not to scale. Property Total and Floor Totals are Internal figures only and do not include Garden, Balconies, Patios or Terraces if any shown. Drawn by SPG.